



ADVANCE  
MICROELECTRONIC  
TECHNOLOGY

# PRODUCT CATALOG

- **Test Sockets**
- **Burn-In Sockets**
- **Cable Assemblies**
- **Electronic Interconnect & Connectors**

**Advance Microelectronic Technology Co., Limited.**

**iCh** 宜技科技有限公司

## Concept

Advance Microelectronic Technology Co., Limited designs, manufactures and delivers high performance, quality Burn-in socket and electric interconnects. Our test sockets are built with high-performance materials and electrical contacts capable of meeting THB, HAST test requirements to ensure reliable and accurate results. we supply application-specific, high-reliability electrical interconnect solutions from highly integrated assemblies to microminiature connectors and spring probe contacts;

We listen carefully to our customers, then align and integrate our comprehensive solution of products and services to fulfill their complete needs. And is committed to growing as an industry Leaders in the design and manufacture of Burn-in system & High-Speed Interconnect.

## Product Design& simulation Technology

We have developed comprehensive simulation technology that makes full use of 3D design and manufacturing to achieve more reliable products.

### 3D Dynamic solid simulation

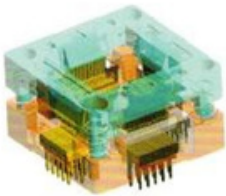

Analyze Burn-in socket actuation of complex structure, simulating the movement process, to verify the performance of the structure, and improving the time efficiency and accuracy of design and development.

### Thermal Simulation

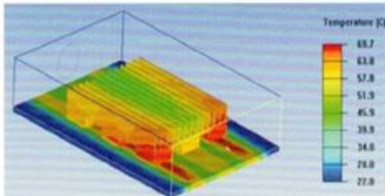

Analyze thermal dissipation properties of socket and Heat Sink by Simulation to optimize Heat Sink Design and socket air convection flow in Burn-in.

### Fatigue Stress & Deflection Simulation



Analyze the fatigue stress and deflection point of each component design with professional software.

### Electrical Performance Contact Simulation

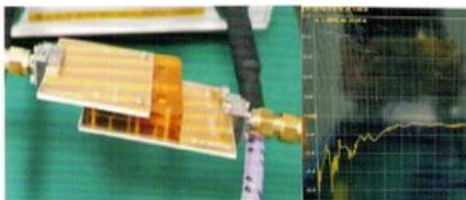

Contact Pin structural and design analysis for high frequency electrical applications.

### Mold Flow Simulation

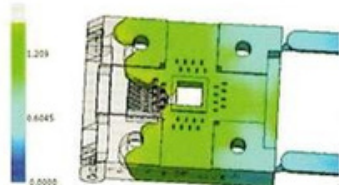

Analyze plastic material flow in mold cavities and fill-up time, gate and core positions designed for efficiency and reliability in plastic injection mold tooling.



# Z-Series SOCKET

(Application IC/QFN&LGA)

## CUSTOM TYPE SOCKET



Z-PIN Series

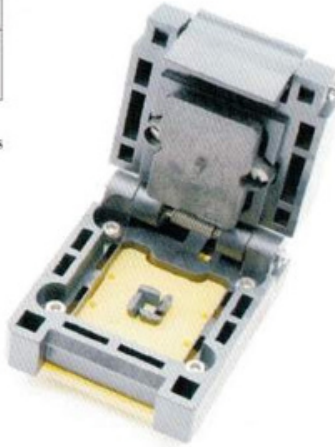

### ORDERING PROCEDURE

QFN - □□□Z - □.□□ - □□□

LGA - □□□Z - □.□□ - □□□

Pin Count

Pitch

Serial No.

Specification	
Contact resistance (Initial)	400mΩ or less (At 10 mA)
Maximum voltage	AC300V RMS( for 1 minute)
Insulation resistance	1,000MΩ or higher (At DC 500V)
Operating temperature range	-65°C~+150°C
Insertion	Min. 5,000 times

Material	
Body	PES
Contact	Plunger/ BS (Ni Alloy), Au plating (PA plating) Spring/ SUS, Au plating

## KEY CONCEPTS & DIMENSIONS

- Compression mount type
- Replaceable contact module
- RoHS compliant
- Any custom DFN/PDFN/QFN/LGA PKG available
- Minimum 0.35mm pitch
- High power and higher temperature performance available
- Dual row pad PKG

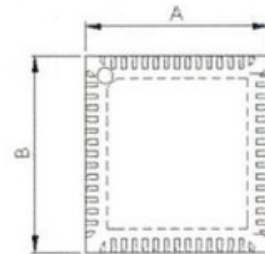

DFN/QFN/LGA PKG

### SOCKET MODULE LINE UP

Unit: mm

Applicable Ic Dimensions			Outside Dimensions(ref.)			Socket Module No.	Heat-skin
Body Size	Row/array	Pitch	D	E	F		
MAX 8X8	Multi	MIN 0.35mm	25	25	17	Z252515-1	No
MAX 12X12	Multi	MIN 0.35mm	40	34	21	Z344046-1	Optional
MAX 20X20	Multi	MIN 0.35mm	47	41.5	22.8	Z424756-1	Standard

Please refer to the attachment for detailed dimensions and Footprint of the socket module.





# Z-Series SOCKET

(Application IC/QFN&LGA)

## CUSTOM TYPE SOCKET

### Socket Line Up

Socket No.	Pin Count	Pitch	Applicable Ic Dimensions(ref.)			Socket Outside Dimensions(ref.)			Mouldle	Heat-Skin	Style	Remarks
			A	B	C	E	F	G				
DFN-14Z-0.40-301(2.00X3.00X0.80)	14	0.4	3	2	0.8	25	25	17	Z252515-1	ClamShell		
DFN-14Z-0.40-101(3.00X2.00X0.75)	14	0.4	3	3	0.75	34	40	21	Z344046-1	ClamShell		
DFN-16Z-010(3X3X0.675)	16	0.45	3	3	0.675	34	40	21	Z344046-1	ClamShell		
DFN-8Z-0.50-301(2.00X3.00X0.75)	8	0.5	3	2	0.75	25	25	17	Z252515-1	ClamShell		
DFN-8Z-0.50-010(2.00X2.00X0.75)	8	0.5	2	2	0.75	34	40	21	Z344046-1	ClamShell		
DFN-8Z-0.50-101(3.00X3.00X0.75)	8	0.5	3	3	0.75	34	40	21	Z344046-1	ClamShell		
DFN-10Z-0.50-301(3.00X3.00X0.75)	10	0.5	3	3	0.75	25	25	17	Z252515-1	ClamShell		
DFN-10Z-0.50-101(3.00X3.00X0.675)	10	0.5	3	3	0.675	34	40	21	Z344046-1	ClamShell		
DFN-10Z-0.50-101(2.50X2.00X0.58)	10	0.5	2.5	2	0.58	34	40	21	Z344046-1	ClamShell		
DFN-10Z-0.50-101(3.00X3.00X0.75)	10	0.5	3	3	0.75	34	40	21	Z344046-1	ClamShell		
DFN-10Z-0.50-101(3.00X3.00X0.75)	10	0.5	3	3	0.75	34	40	21	Z344046-1	ClamShell		
DFN-12Z-0.50-101(3.20X4.00X1.75)	12	0.5	3.2	4	1.75	34	40	21	Z344046-1	ClamShell		
DFN-14Z-0.50-101(4.00X3.00X0.75)	14	0.5	4	3	0.75	34	40	21	Z344046-1	ClamShell		
DFN-16Z-0.50-101(5.00X4.00X0.75)	16	0.5	5	4	0.75	34	40	21	Z344046-1	ClamShell		
DFN-20Z-0.50-101(5.50X4.00X1.40)	20	0.5	5.5	4	1.4	34	40	21	Z344046-1	ClamShell		
DFN-2Z-0.65-010(1.00X0.60X0.50)	2	0.65	1	0.6	0.5	34	40	21	Z344046-1	ClamShell		
DFN-6Z-0.65-101(2.00X2.00X0.75)	6	0.65	2	2	0.75	34	40	21	Z344046-1	ClamShell		
DFN-6Z-0.65-010(2.00X2.00X0.75).2	6	0.65	2	2	0.75	34	40	21	Z344046-1	ClamShell		
DFN-8Z-0.65-101(3.00X3.00X0.75)	8	0.65	3	3	0.75	34	40	21	Z344046-1	ClamShell		
DFN-10Z-0.80-010(4.10X2.00X0.50)	10	0.8	4.1	2	0.5	34	40	21	Z344046-1	ClamShell		
DFN-10Z-0.80-101(4.00X4.00X0.75)	10	0.8	4	4	0.75	34	40	21	Z344046-1	ClamShell		
DFN-6Z-0.95-010(3.00X3.00X0.70)	6	0.95	3	3	0.7	34	40	21	Z344046-1	ClamShell		
DFN-6Z-0.95-101(3.00X2.40X0.75)	6	0.95	3	2.4	0.75	34	40	21	Z344046-1	ClamShell		
DFN-8Z-1.00-010(6.00X4.00X0.85)	8	1	6	4	0.85	34	40	21	Z344046-1	ClamShell		
DFN-2Z-1.10-010(1.60X1.00X0.50)	2	1.1	1.6	1	0.5	34	40	21	Z344046-1	ClamShell		
DFN-5Z-1.14-101(9.40X6.50X2.20)	5	1.14	9.4	6.5	2.2	34	40	21	Z344046-1	ClamShell		
DFN-8Z-1.27-010(6.00X5.00X0.75)	8	1.27	6	5	0.75	34	40	21	Z344046-1	ClamShell		
DFN-8Z-1.27-101(6.00X5.00X0.75)	8	1.27	6	5	0.75	34	40	21	Z344046-1	ClamShell		
DFN-3Z-1.30-010(2.00X2.00X0.55)	3	1.3	2	2	0.55	34	40	21	Z344046-1	ClamShell		
DFN-8Z-2.54-201(12.70X10.00X4.75)	8	2.54	12.7	10	4.75	41.5	47	24.8	Z424756-1	ClamShell		
DFN-13Z-3.00-010(13.00X13.00X1.30)	13	3	13	13	1.3	34	40	21	Z344046-1	ClamShell		
LGA-10Z-0.40-010(1.10X1.50X0.58)	10	0.4	1.1	1.5	0.58	34	40	21	Z344046-1	ClamShell		
LGA-60Z-0.40-010(7.00X7.00X0.60)	60	0.4	7	7	0.6	34	40	21	Z344046-1	ClamShell		
LGA-324Z-0.40-101(7.50X7.50X1.00)	324	0.4	7.5	7.5	1	34	40	21	Z344046-1	ClamShell		
LGA-112Z-0.80-201(16.10X21.10X3.75)	112	0.8	16.1	21.1	3.75	41.5	47	24.8	Z424756-1	Yes	ClamShell	
LGA-112Z-0.80-201(16.10X21.10X3.05)	112	0.8	16.1	21.1	3.05	41.5	47	24.8	Z424756-1	Yes	ClamShell	
LGA-41Z-1.27-202(15.40X15.40X5.00)	41	1.27	15.4	15.4	5	41.5	47	24.8	Z424756-1		ClamShell	
PDFN-8Z-0.65-101(3.00X3.00X0.78)	8	0.65	3	3	0.78	34	40	21	Z344046-1	ClamShell		
QFN-56P-0.35-101(6.00X6.00X0.55)	56	0.35	6	6	0.55	34	40	21	Z344046-1	ClamShell		
QFN-60Z-0.35-101(6.00X6.00X0.85)	60	0.35	6	6	0.85	34	40	21	Z344046-1	ClamShell		
QFN-80P-0.35-010(8.00X8.00X0.85)	80	0.35	8	8	0.85	34	40	21	Z344046-1	ClamShell		
QFN-80Z-0.35-101(8.00X8.00X0.85)	80	0.35	8	8	0.85	34	40	21	Z344046-1	ClamShell		
QFN-8Z-0.40-010(2.00X1.50X0.85)	8	0.4	2	1.5	0.85	34	40	21	Z344046-1	ClamShell		
QFN-20Z-0.40-301(3.00X3.00X0.75)	20	0.4	3	3	0.75	25	25	17	Z252515-1	ClamShell		
QFN-20Z-0.40-101(3.00X3.00X0.75)	20	0.4	3	3	0.75	34	40	21	Z344046-1	ClamShell		
QFN-21Z-0.40-101(3.00X4.00X0.85)	21	0.4	3	4	0.85	34	40	21	Z344046-1	ClamShell		
QFN-22Z-0.40-010(2.50X2.90X0.975)	22	0.4	2.5	2.9	0.975	34	40	21	Z344046-1	ClamShell		
QFN-28Z-0.40-010(4.00X4.00X0.70)	28	0.4	4	4	0.7	34	40	21	Z344046-1	ClamShell		
QFN-28Z-0.40-101(4.00X4.00X0.75)	28	0.4	4	4	0.75	34	40	21	Z344046-1	ClamShell		
QFN-32Z-0.40-010(4.00X4.00X0.75)	32	0.4	4	4	0.75	34	40	21	Z344046-1	ClamShell		

\* If you need further details or have any questions regarding other models, please contact our local representative.





# Z-Series SOCKET

(Application IC/QFN&LGA)

## CUSTOM TYPE SOCKET

### Socket Line Up

Socket No.	Pin Count	Pitch	Applicable Ic Dimensions(ref.)			Socket Outside Dimensions(ref.)			Moudle	Heat-Skin	Style	Remarks
			A	B	C	E	F	G				
QFN-36Z-0.40-101(5.00X5.00X0.75)	36	0.4	5	5	0.75	34	40	21	Z344046-1		ClamShell	
QFN-40Z-0.40-010(6X4XT0.75)	40	0.4	6	4	0.75	34	40	21	Z344046-1		ClamShell	
QFN-40Z-0.40-101(5.00X5.00X0.75)	40	0.4	5	5	0.75	34	40	21	Z344046-1		ClamShell	
QFN-44Z-0.40-101(6.50X4.00X0.85)	44	0.4	6.5	4	0.85	34	40	21	Z344046-1		ClamShell	
QFN-46Z-0.4-010	46	0.4	6.5	4.5	0.85	34	40	21	Z344046-1		ClamShell	
QFN-48Z-0.40-101(6.00X6.00X0.75)	48	0.4	6	6	0.75	34	40	21	Z344046-1		ClamShell	
QFN-52Z-0.4-010	52	0.4	6	6	0.85	34	40	21	Z344046-1		ClamShell	
QFN-52Z-0.40-101(6.00X6.00X0.75)	52	0.4	6	6	0.75	34	40	21	Z344046-1		ClamShell	
QFN-52Z-0.40-101(6.00X6.00X0.85)	52	0.4	6	6	0.85	34	40	21	Z344046-1		ClamShell	
QFN-56Z-0.4-010(7X7)	56	0.4	7	7	0.75	34	40	21	Z344046-1		ClamShell	
QFN-56Z-0.40-101(7.00X7.00X0.75)	56	0.4	7	7	0.75	34	40	21	Z344046-1		ClamShell	
QFN-60Z-0.4-010	60	0.4	7	7	0.85	34	40	21	Z344046-1		ClamShell	
QFN-60Z-0.40-010 (7.00X7.00X0.75)	60	0.4	7	7	0.75	34	40	21	Z344046-1		ClamShell	
QFN-64Z-0.40-101(8.00X8.00X1.00)	64	0.4	8	8	1	34	40	21	Z344046-1		ClamShell	
QFN-64Z-0.40-010 (8.00X8.00X0.75))	64	0.4	8	8	0.75	34	40	21	Z344046-1		ClamShell	
QFN-66Z-0.40-101(5.00X10.00X0.85)	66	0.4	5	10	0.85	34	40	21	Z344046-1		ClamShell	
QFN-68Z-0.40-101(8.00X8.00X0.75)	68	0.4	8	8	0.75	34	40	21	Z344046-1		ClamShell	
QFN-88Z-0.40-101(10.00X10.00X0.85)	88	0.4	10	10	0.85	34	40	21	Z344046-1		ClamShell	
QFN-28Z-0.44-010(4.00X3.65X0.85)	28	0.44	4	3.65	0.85	34	40	21	Z344046-1		ClamShell	
QFN-48Z-0.44-010(6.80X4.00X0.80)	48	0.44	6.8	4	0.8	34	40	21	Z344046-1		ClamShell	
QFN-10Z-0.45-010(3X3X2.1)	10	0.45	3	3	2.1	34	40	21	Z344046-1		ClamShell	
QFN-10Z-0.45-101(3.00X3.00X1.10)	10	0.45	3	3	1.1	34	40	21	Z344046-1		ClamShell	
QFN-12Z-0.45-101(3.00X3.00X0.60)	12	0.45	3	3	0.6	34	40	21	Z344046-1		ClamShell	
QFN-14Z-0.45-010(2.00X2.00X0.527)	14	0.45	2	2	0.527	34	40	21	Z344046-1		ClamShell	
QFN-16Z-0.45-010(3.00X3.00X0.70)	16	0.45	3	3	0.7	34	40	21	Z344046-1		ClamShell	
QFN-16Z-0.45-010.2(3.00X3.00X0.70)	16	0.45	3	3	0.7	34	40	21	Z344046-1		ClamShell	
QFN-18Z-0.45-101(4.00X4.00X0.75)	18	0.45	4	4	0.75	34	40	21	Z344046-1		ClamShell	
QFN-20Z-0.45-010(5X5X2.0)	20	0.45	5	5	2	34	40	21	Z344046-1		ClamShell	
QFN-25Z-0.45-101(4.00X4.00X0.70)	25	0.45	4	4	0.7	34	40	21	Z344046-1		ClamShell	
QFN-38Z-0.45-101(5.00X6.00X0.90)	38	0.45	5	6	0.9	34	40	21	Z344046-1		ClamShell	
QFN-5Z-0.48-301(0.80X0.80X0.40)	5	0.48	0.8	0.8	0.4	25	25	17	Z252515-1		ClamShell	
QFN-38Z-0.48-010(5.50X5.30X0.75)	38	0.48	5.5	5.3	0.75	34	40	21	Z344046-1		ClamShell	
QFN-9Z-0.50-101(2.00X1.50X1.00)	9	0.5	2	1.5	1	34	40	21	Z344046-1		ClamShell	
QFN-10Z-101(2.00X2.00X0.55)	10	0.5	2	2	0.55	25	25	17	Z252515-1		ClamShell	
QFN-10Z-101(2.00X2.00X0.675)	10	0.5	2	2	0.675	34	40	21	Z344046-1		ClamShell	
QFN-10Z-0.50-101(3.00X3.00X0.90)	10	0.5	3	3	0.9	34	40	21	Z344046-1		ClamShell	
QFN-12Z-0.50-101(2.50X2.50X0.55)	12	0.5	2.5	2.5	0.55	34	40	21	Z344046-1		ClamShell	
QFN-16Z-0.50-301(3.00X3.00X0.75)	16	0.5	3	3	0.75	25	25	17	Z252515-1		ClamShell	
QFN-16Z-0.50-101(3.00X3.00X0.75)	16	0.5	3	3	0.75	34	40	21	Z344046-1		ClamShell	
QFN-16Z-0.50-101(3.00X3.00X0.55)	16	0.5	3	3	0.55	34	40	21	Z344046-1		ClamShell	
QFN-20Z-0.50-010(4X4T0.75)	20	0.5	4	4	0.75	34	40	21	Z344046-1		ClamShell	
QFN-20Z-0.50-101(3.50X3.50X0.75)	20	0.5	3.5	3.5	0.75	34	40	21	Z344046-1		ClamShell	
QFN-20Z-0.50-101(4.00X4.00X0.85)	20	0.5	4	4	0.85	34	40	21	Z344046-1		ClamShell	
QFN-24Z-0.50-301(4.00X5.00X0.80)	24	0.5	5	4	0.8	25	25	17	Z252515-1		ClamShell	
QFN-24Z-0.50-010(4X4)	24	0.5	4	4	1.2	34	40	21	Z344046-1		ClamShell	
QFN-24Z-0.50-101(4.50X3.50X0.75)	24	0.5	4.5	3.5	0.75	34	40	21	Z344046-1		ClamShell	
QFN-24Z-0.50-101(4.00X4.00X0.75)	24	0.5	4	4	0.75	34	40	21	Z344046-1		ClamShell	
QFN-28Z-0.50-101(5.00X5.00X0.75)	28	0.5	5	5	0.75	34	40	21	Z344046-1		ClamShell	
QFN-32Z-0.50-010(5X5X0.75)	32	0.5	5	5	0.75	34	40	21	Z344046-1		ClamShell	
QFN-32-0.50-010(5X5X1.1)	32	0.5	5	5	1.1	34	40	21	Z344046-1		ClamShell	

\*If you need further details or have any questions regarding other models, please contact our local representative.





# Z-Series SOCKET

(Application IC/QFN&LGA)

## CUSTOM TYPE SOCKET

### Socket Line Up

Socket No.	Pin Count	Pitch	Applicable Ic Dimensions(ref.)			Socket Outside Dimensions(ref.)			Moudle	Heat-Skin	Style	Remarks
			A	B	C	E	F	G				
QFN-32Z-0.50-101(5.00X5.00X0.75)	32	0.5	5	5	0.75	34	40	21	Z344046-1		ClamShell	
QFN-32Z-0.5-010	32	0.5	5	5	0.75	34	40	21	Z344046-1		ClamShell	
QFN-38Z-0.50-101(5.00X7.00X0.75)	38	0.5	5	7	0.75	34	40	21	Z344046-1		ClamShell	
QFN-40Z-0.50-101(6.00X6.00X0.82)	40	0.5	6	6	0.82	34	40	21	Z344046-1		ClamShell	
QFN-42Z-0.5(3.50X9.00X0.70)	42	0.5	3.5	9	0.7	34	40	21	Z344046-1		ClamShell	
QFN-48Z-0.50-010 (7.00X7.00X0.85)	48	0.5	7	7	0.85	34	40	21	Z344046-1		ClamShell	
QFN-64Z-0.50-101(9.00X9.00X0.75)	64	0.5	9	9	0.75	34	40	21	Z344046-1		ClamShell	
QFN-64Z-0.50-010 (9.00X9.00X0.75)	64	0.5	9	9	0.75	34	40	21	Z344046-1		ClamShell	
QFN-84Z-0.50-101(7.00X7.00X0.85)	84	0.5	7	7	0.85	34	40	21	Z344046-1		ClamShell	
QFN-120Z-0.50-010(10.00X10.00X0.85)	120	0.5	10	10	0.85	34	40	21	Z344046-1		ClamShell	
QFN-120Z-0.50-101(10.00X10.00X0.85)	120	0.5	10	10	0.85	34	40	21	Z344046-1		ClamShell	
QFN-128Z-0.50-101(10.00X10.00X0.85)	128	0.5	10	10	0.85	34	40	21	Z344046-1		ClamShell	
QFN-129Z-0.50-010	129	0.5	10	10	0.85	34	40	21	Z344046-1		ClamShell	
QFN-132Z-0.5-010	132	0.5	10	10	0.85	34	40	21	Z344046-1		ClamShell	
QFN-132Z-0.50-101(10.00X10.00X0.75)	132	0.5	10	10	0.75	34	40	21	Z344046-1		ClamShell	
QFN-156Z-0.50-101(12.00X12.00X0.85)	156	0.5	12	12	0.85	34	40	21	Z344046-1		ClamShell	
QFN-164Z-0.50-101(12.00X12.00X0.85)	164	0.5	12	12	0.85	34	40	21	Z344046-1		ClamShell	
QFN-14Z-0.60-010(3.0X4.2X0.9)	14	0.6	3	4.2	0.9	34	40	21	Z344046-1		ClamShell	
QFN-14Z-0.60-010(3.00X4.20X0.90).2	14	0.6	3	4.2	0.9	34	40	21	Z344046-1		ClamShell	
QFN-24Z-0.60-101(5.00X4.00X0.82)	24	0.6	5	4	0.82	34	40	21	Z344046-1		ClamShell	
QFN-6Z-0.65-010(2.00X2.00X0.75)	6	0.65	2	2	0.75	34	40	21	Z344046-1		ClamShell	
QFN-8Z-0.65-301(3.00X3.00X1.00)	8	0.65	3	3	1	34	40	21	Z344046-1		ClamShell	
QFN-14Z-0.65-010(4.00X4.00X0.75)	14	0.65	4	4	0.75	34	40	21	Z344046-1		ClamShell	
QFN-24Z-0.65-101(4.50X6.00X2.45)	24	0.65	6	4.5	2.45	34	40	21	Z344046-1		ClamShell	
QFN-28Z-0.65-101(7.00X5.00X0.65)	28	0.65	7	5	0.65	34	40	21	Z344046-1		ClamShell	
QFN-28Z-0.65-101(5.00X7.00X2.30)	28	0.65	5	7	2.3	34	40	21	Z344046-1		ClamShell	
QFN-32Z-0.65-010 (7.00X7.00X2.05)	32	0.65	7	7	2.05	34	40	21	Z344046-1	Yes	ClamShell	
QFN-32Z-0.65-101(7.00X7.00X2.30)	32	0.65	7	7	2.3	34	40	21	Z344046-1		ClamShell	
QFN-39Z-0.65-010	39	0.65	12	12	0.85	34	40	21	Z344046-1		ClamShell	
QFN-40Z-0.65-101(8.00X8.00X4.40)	40	0.65	8	8	2.3	34	40	21	Z344046-1		ClamShell	
QFN-40Z-0.65-101(8.00X8.00X4.40)	40	0.65	8	8	4.4	41.5	47	24.8	Z424756-1		ClamShell	
QFN-44Z-0.65-101(8.00X8.00X2.40)	44	0.65	8	8	2.4	34	40	21	Z344046-1		ClamShell	
QFN-30Z-0.675-101(6.00X6.00X0.90)	30	0.675	6	6	0.9	34	40	21	Z344046-1		ClamShell	
QFN-28Z-0.50-010(5.00X5.00X0.75)	28	0.75	5	5	0.75	34	40	21	Z344046-1		ClamShell	
QFN-30Z-0.75-010(7.00X6.00X0.73)	30	0.75	7	6	0.73	34	40	21	Z344046-1		ClamShell	
QFN-16Z-0.80-101(5.00X5.00X2.00)	16	0.8	5	5	2	34	40	21	Z344046-1		ClamShell	
QFN-16Z-0.80-101 (5.00X5.00X2.20)	16	0.8	5	5	2.2	34	40	21	Z344046-1	Yes	ClamShell	
QFN-24Z-0.80-101(6.00X6.00X3.80)	24	0.8	6	6	3.8	34	40	21	Z344046-1		ClamShell	
QFN-42Z-0.80-101(11.00X9.00X2.00)	42	0.8	11	9	2	34	40	21	Z344046-1		ClamShell	
QFN-52Z-0.80-101(10.00X10.00X3.00)	52	0.8	10	10	3	34	40	21	Z344046-1		ClamShell	
QFN-7Z-1.27-101(11.91X10.16X4.10)	7	1.27	11.91	10.16	4.1	34	40	21	Z344046-1		ClamShell	
QFN-18Z-1.27-010(8.89X7.24X2.25)	18	1.27	8.89	7.24	2.25	34	40	21	Z344046-1		ClamShell	
QFN-25Z-1.27-101(7.45X7.45X3.20)	25	1.27	7.45	7.45	3.2	41.5	47	24.8	Z424756-1		ClamShell	
QFN-28Z-1.27-010(11.43X11.43X4.05)	28	1.27	11.43	11.43	4.05	34	40	21	Z344046-1		ClamShell	
QFN-41Z-1.27-201(15.00X15.00X2.82)	41	1.27	15	15	2.82	41.5	47	24.8	Z424756-1	Yes	ClamShell	
QFN-8Z-2.54-101(12.70X10.00X3.95)	8	2.54	12.7	10	3.95	34	40	21	Z344046-1		ClamShell	
VQFN-32Z-0.4-010(4X4)	32	0.4	4	4	0.85	34	40	21	Z344046-1		ClamShell	
VQFN-40Z-0.4-010(5X5)	40	0.4	5	5	0.85	34	40	21	Z344046-1		ClamShell	
VQFN-40Z-0.5-010	40	0.5	6	6	0.85	34	40	21	Z344046-1		ClamShell	

\*If you need further details or have any questions regarding other models, please contact our local representative.





# Z-Series SOCKET

(Application IC/BGA&WLCSP)

## CUSTOM TYPE SOCKET



Z-PIN Series



### ORDERING PROCEDURE

**BGA** - □□□z - □.□□ - □□□

**CSP** - □□□z - □.□□ - □□□

Pin Count      Pitch      Serial No.

Specification	
Contact resistance (Initial)	400mΩ or less (At 10 mA)
Maximum voltage	AC300V RMS( for 1 minute)
Insulation resistance	1,000MΩ or higher (At DC 500V)
Operating temperature range	-65°C~+150°C
Insertion	Min. 5,000 times

Material	
Body	PES
Contact	Plunger/ BS (Ni Alloy), Au plating (PA plating) Spring/ SUS, Au plating

## KEY CONCEPTS & DIMENSIONS

- Compression mount type
- Replaceable contact module
- RoHS compliant
- Any custom BGA & WLCSP PKG available
- Minimum 0.35mm pitch
- High power and higher temperature performance available

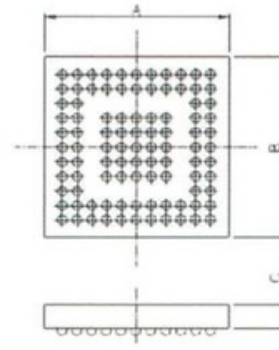

BGA/CSP PKG

### SOCKET MODULE LINE UP

Unit: mm

Applicable Ic Dimensions			Outside Dimensions(ref.)			Socket Module No.	Heat-skin
Body Size	Row/array	Pitch	D	E	F		
MAX 8X8	Multi	MIN 0.35mm	25	25	17	Z252515-1	No
MAX 12X12	Multi	MIN 0.35mm	40	34	21	Z344046-1	Optional
MAX 20X20	Multi	MIN 0.35mm	47	41.5	22.8	Z424756-1	Standard

Please refer to the attachment for detailed dimensions and Footprint of the socket module.





# Z-Series SOCKET

(Application IC/BGA&WLCSP)

## CUSTOM TYPE SOCKET

### Socket Line Up

Socket No.	Pin Count	Pitch	Applicable Ic Dimensions(ref.)			Socket Outside Dimensions(ref.)			Mouldle	Heat-Skin	Style	Remarks
			A	B	C	E	F	G				
BGA-16P-0.35-010(1.50X1.55X0.50)	16	0.35	1.5	1.55	0.5	34	40	21	Z344046-1		ClamShell	
BGA-15Z-0.40-010(1.49X2.38X0.505)	15	0.4	1.49	2.38	0.505	34	40	21	Z344046-1		ClamShell	
BGA-36Z-0.40-010	36	0.4	2.6	2.6	0.2	34	40	21	Z344046-1		ClamShell	
BGA-36Z-0.40-101(3.00X3.00X0.58)	36	0.4	3	3	0.58	34	40	21	Z344046-1		ClamShell	
BGA-42Z-0.40-010	42	0.4	3.2	3.2	0.2	34	40	21	Z344046-1		ClamShell	
BGA-49Z-0.40-010(3.02X3.02X0.58)	49	0.4	3.02	3.02	0.58	34	40	21	Z344046-1		ClamShell	
BGA-60Z-0.40-010(2.70X4.40X1.14)	60	0.4	2.7	4.4	1.14	34	40	21	Z344046-1		ClamShell	
BGA-61Z-0.40-010(3.32X3.55)	61	0.4	3.32	3.55	0.385	34	40	21	Z344046-1		ClamShell	
BGA-70Z-0.40-101(4.70X4.10X0.88)	70	0.4	4.7	4.1	0.88	34	40	21	Z344046-1		ClamShell	
BGA-79Z-0.40-010(3.805X3.82)	79	0.4	3.805	3.82	0.385	34	40	21	Z344046-1		ClamShell	
BGA-97Z-0.40-010	97	0.4	5	5	0.65	34	40	21	Z344046-1		ClamShell	
BGA-216Z-0.40-101(5.80X8.60X0.96)	216	0.4	5.8	8.6	0.96	34	40	21	Z344046-1		ClamShell	
BGA-216Z-0.40-102(5.80X8.60X0.96)	216	0.4	5.8	8.6	0.96	34	40	21	Z344046-1		ClamShell	
BGA-216Z-0.40-103(5.80X8.60X0.96)	216	0.4	5.8	8.6	0.96	34	40	21	Z344046-1		ClamShell	
BGA-216Z-0.40-104(5.80X8.60X0.96)	216	0.4	5.8	8.6	0.96	34	40	21	Z344046-1		ClamShell	
BGA-247Z-0.40-101(7.70X7.70X0.85)	247	0.4	7.7	7.7	0.85	34	40	21	Z344046-1		ClamShell	
BGA-293Z-0.40-020	293	0.4	8.5	7.8	0.932	41.5	47	24.8	Z424756-1	Yes	ClamShell	
BGA-729Z-0.40-020(11.8X11.8)	729	0.4	11.8	11.8	0.666	41.5	47	24.8	Z424756-1	Yes	ClamShell	
BGA-116Z-0.495-010(4.07X3.97X0.55)	116	0.5	4.07	3.97	0.55	34	40	21	Z344046-1		ClamShell	
BGA-8Z-0.50-101(2.00X2.00X0.74)	8	0.5	2	2	0.74	34	40	21	Z344046-1		ClamShell	
BGA-36Z-0.50-101(3.00X3.00X0.58)	36	0.5	3	3	0.58	34	40	21	Z344046-1		ClamShell	
BGA-51Z-0.50-010(4.50X4.50X1.14)	51	0.5	4.5	4.5	1.14	34	40	21	Z344046-1		ClamShell	
BGA-111Z-0.50-010(6.65X6.64X0.805)	111	0.5	6.65	6.64	0.805	34	40	21	Z344046-1		ClamShell	
BGA-192Z-0.50-101(8.50X9.00X1.20)	192	0.5	8.5	9	1.2	34	40	21	Z344046-1		ClamShell	
BGA-253Z-0.50-010(8.00X13.50X1.30)	253	0.5	8	13.5	1.3	34	40	21	Z344046-1		ClamShell	
BGA-226Z-0.65-101(11.00X11.00X1.20)	226	0.65	11	11	1.2	34	40	21	Z344046-1		ClamShell	
BGA-201Z-0.65-201(10.00X10.00X0.45)	201	0.65	10	10	0.45	41.5	47	24.8	Z424756-1	Yes	ClamShell	
BGA-288Z-201(12.00X12.00X1.27)	288	0.65	12	12	1.27	41.5	47	24.8	Z424756-1	Yes	ClamShell	
BGA-380Z-0.65-201(13.00X13.00X1.12)	380	0.65	13	13	1.12	41.5	47	24.8	Z424756-1	Yes	ClamShell	
BGA-355Z-0.75-201(15.00X15.00X1.20)	355	0.75	15	15	1.26	41.5	47	24.8	Z424756-1	Yes	ClamShell	
BGA-48Z-0.80-101(8.00X6.00X1.10)	48	0.8	8	6	1.1	34	40	21	Z344046-1		ClamShell	
BGA-63Z-0.80-101(11.00X9.00X1.00)	63	0.8	11	9	1	34	40	21	Z344046-1		ClamShell	
BGA-144Z-0.80-201(10.00X10.00X1.00)	144	0.8	10	10	1	41.5	47	24.8	Z424756-1	Yes	ClamShell	
BGA-208Z-0.80-020(12X12X1.36)	208	0.8	12	12	1.36	41.5	47	24.8	Z424756-1	Yes	ClamShell	
BGA-64Z-1.00-101(10.00X13.00X1.20)	64	1	10	13	1.2	34	40	21	Z344046-1		ClamShell	
BGA-484Z-1.00-X02(23.00X23.00X1.70)	484	1	23	23	1.7	41.5	47	24.8	Z424756-1	Yes	ClamShell	
BGA-25Z-1.27-101(7.45X7.45X4.00)	25	1.27	7.45	7.45	4	34	40	21	Z344046-1		ClamShell	
BGA-26Z-1.27-201(15.00X11.25X3.42)	26	1.27	15	11.25	3.42	41.5	47	24.8	Z424756-1		ClamShell	
BGA-30Z-1.27-201(15.00X9.00X3.50)	30	1.27	15	9	3.5	41.5	47	24.8	Z424756-1		ClamShell	
BGA-41Z-1.27-202(15.40X15.40X5.00)	41	1.27	15.4	15.4	5	41.5	47	24.8	Z424756-1		ClamShell	
BGA-41Z-1.27-201(15.00X15.00X3.42)	41	1.27	15	15	3.42	41.5	47	24.8	Z424756-1		ClamShell	
BGA-43Z-1.27-201(15.40X15.40X5.00)	43	1.27	15.4	15.4	5	41.5	47	24.8	Z424756-1	Yes	ClamShell	
BGA-43Z-1.27-201(16.50X16.50X5.07)	43	1.27	16.5	16.5	5.07	41.5	47	24.8	Z424756-1	Yes	ClamShell	
BGA-44Z-1.27-201(15.00X15.00X4.70)	44	1.27	15	15	4.7	41.5	47	24.8	Z424756-1	Yes	ClamShell	
BGA-44Z-1.27-201(15.50X15.50X5.67)	44	1.27	15.5	15.5	5.67	41.5	47	24.8	Z424756-1	Yes	ClamShell	
BGA-44Z-1.27-201(15.00X15.00X4.70)	44	1.27	15	15	4.7	41.5	47	24.8	Z424756-1	Yes	ClamShell	
BGA-104Z-1.27-201(16.50X16.50X3.92)	104	1.27	16.5	16.5	3.92	41.5	47	24.8	Z424756-1	Yes	ClamShell	
BGA-269Z-1.27-201(17.00X17.00X3.90)	269	1.27	17	17	3.9	41.5	47	24.8	Z424756-1	Yes	ClamShell	
WCSP-16Z-0.40-010(1.666X1.666X0.625)	16	0.4	1.666	1.666	0.625	34	40	21	Z344046-1		ClamShell	

\*If you need further details or have any questions regarding other models, please contact our local representative.





# Z-Series SOCKET

(Application IC/Custom Module&Other Package)

CUSTOM TYPE SOCKET

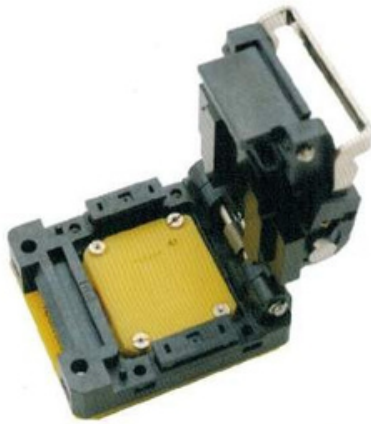

## ORDERING PROCEDURE

□□□ - □□□Z - □.□□ - □□□

Pkg Name Pin Count Pitch Serial No.

Specification	
Contact resistance (Initial)	400mΩ or less (At 10 mA)
Maximum voltage	AC300V RMS( for 1 minute)
Insulation resistance	1,000MΩ or higher (At DC 500V)
Operating temperature range	-65℃~+150℃
Insertion	Min. 5,000 times

Material	
Body	PES
Contact	Plunger/ BS (Ni Alloy), Au plating (PA plating) Spring/ SUS, Au plating

## KEY CONCEPTS & DIMENSIONS

- Compression mount type
- Replaceable contact module
- RoHS compliant
- Any custom Module& Other package available
- Flexible Pitch minimum 0.35~2.54 mm pitch
- High power and higher temperature performance available
- Independent temperature control can be achieved using sensors and heaters

## SOCKET MODULE LINE UP

Unit: mm

Applicable Ic Dimensions			Outside Dimensions(ref.)			Socket Module No.	Heat-skin
Body Size	Row/array	Pitch	D	E	F		
MAX 8X8	Multi	MIN 0.35mm	25	25	17	Z252515-1	No
MAX 12X12	Multi	MIN 0.35mm	40	34	21	Z344046-1	Optional
MAX 20X20	Multi	MIN 0.35mm	47	41.5	22.8	Z424756-1	Standard

Please refer to the attachment for detailed dimensions and Footprint of the socket module.





# Z-Series SOCKET

(Attachment: Module Dimensions & Footprint)

## CUSTOM TYPE SOCKET

### SOCKET MOUDLE- Z252515-1

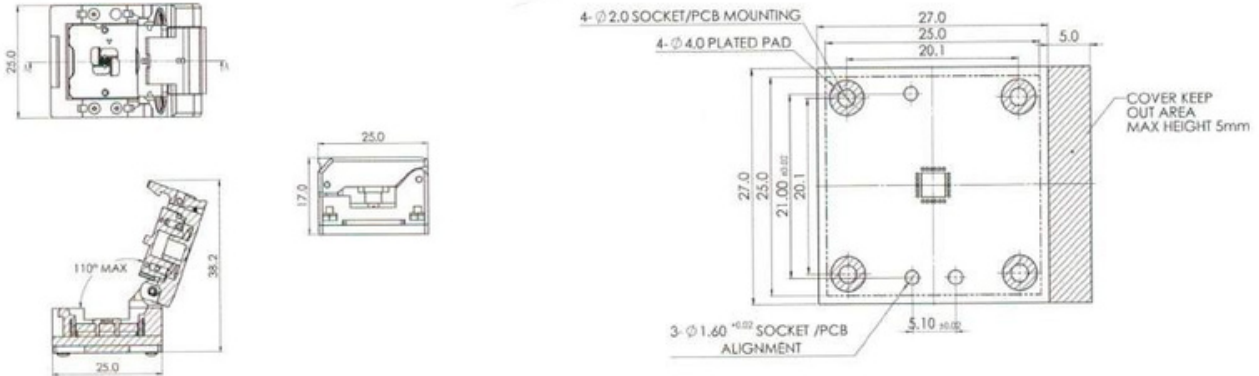

### SOCKET MOUDLE- Z344046-1

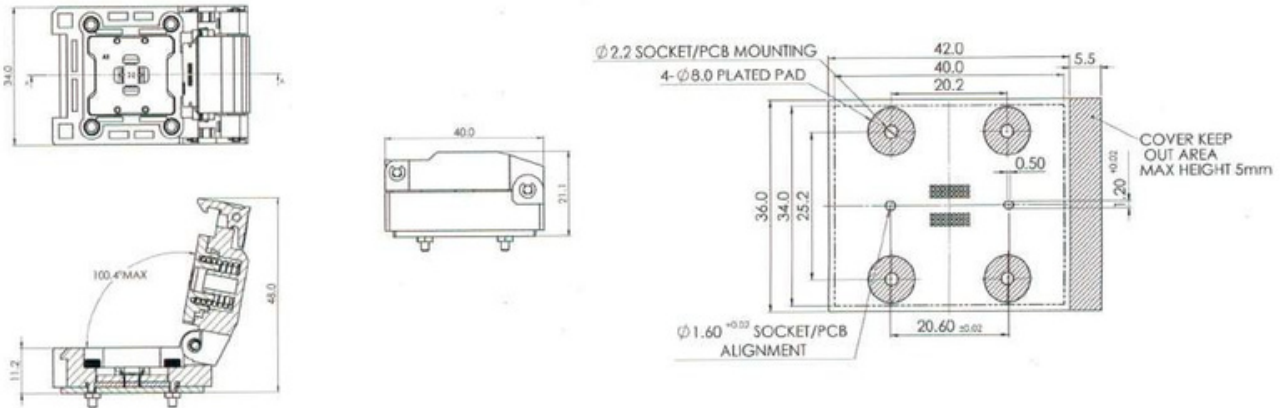

### SOCKET MOUDLE- Z424756-1

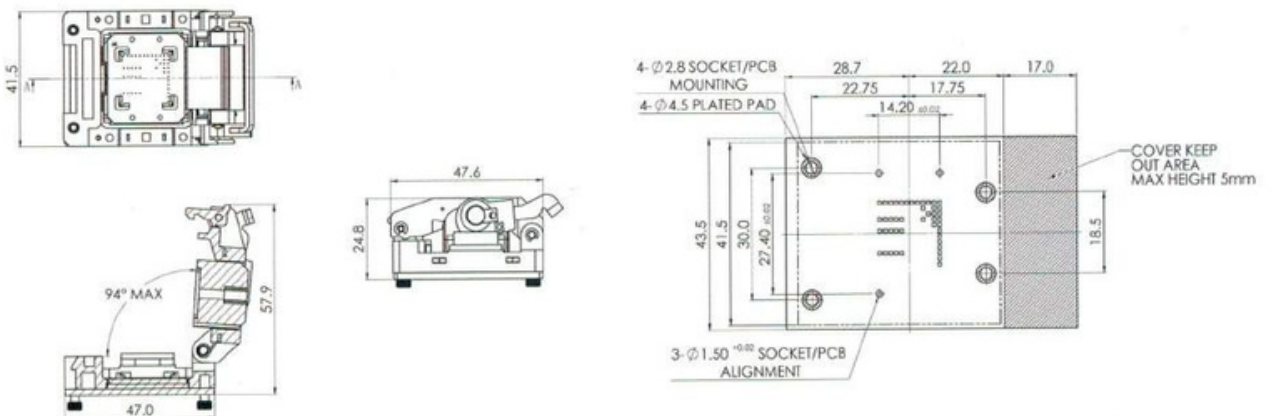



# TEST SOCKET

# QFP/QUAD FLAT PACKAGE



### ORDERING PROCEDURE

**QFP11T** □□□ - P□□□ - □□□

**OTQ11T** □□□ - P□□□ - □□□

Pin Count      Pitch      Serial No.

Specification	
Contact resistance (Initial)	400mΩ or less (At 10 mA)
Maximum voltage	AC700V RMS (for 1 minute) Below 0.5mm pitch AC500V RMS (for 1 minute)
Rated current	1A
Insulation resistance	1,000MΩ or higher (At DC 500V)
Operating temperature range	- 65°C ~ +150°C
Insertion	Min. 5,000 times

Material	
Body	PPS,PES
Contact	BeCu, Au plating(Ni-base)

\*Rohs compliant

## APPLICABLE IC DIMENSIONS & SOCKET DIMENSIONS

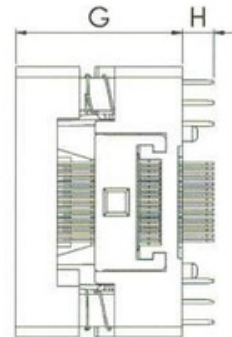
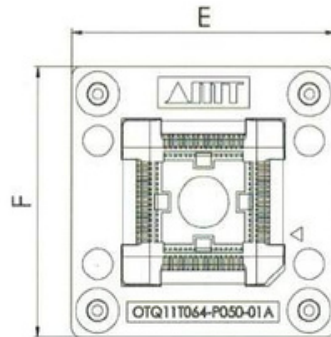
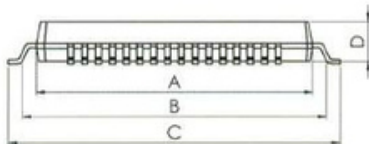
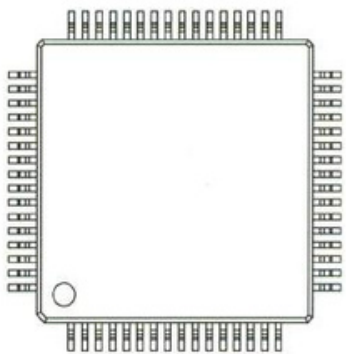

Outline open top socket dimensions

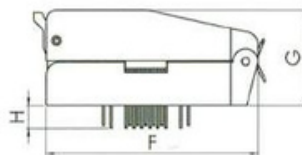
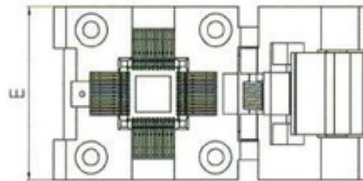

Outline clamshell socket dimensions





## QFP Socket Line Up (Pitch0.40-1.00mm)

### Clam Shell Type

Socket NO.	Pin Count	Pitch	Applicable Ic Dimensions(ref.)			Socket Outside Dimensions(ref.)				Remarks
			A	B	C	E	F	G	H	
QFP11T064-P040-01A	64	0.4	10x10	11x11	12X12	29	32	18.5	2.9	With Floating
QFP11T100-P040-01A	100	0.4	12x12	13X13	14X14	36	42.5	18.5	2.9	With Floating
QFP11T128-P040-01A	128	0.4	14X14	15X15	16X16	36	42.5	18.5	2.9	With Floating
QFP11T144-P040-01A	144	0.4	16X16	17X17	18X18	39	42.5	18.5	2.9	With Floating
QFP11T032-P050-01A	32	0.5	5X5	6x6	7X7	29	32	18.5	2.9	With Floating
QFP11T048-P050-01A	48	0.5	7x7	8x8	9X9	29	32	18.5	2.9	With Floating
QFP11T064-P050-01A	64	0.5	10x10	11x11	12X12	32	37.5	18.5	2.9	With Floating
QFP11T080-P050-01A	80	0.5	12x12	13x13	14X14	34	39.5	18.5	2.9	With Floating
QFP11T100-P050-01A	100	0.5	14x14	15x15	16X16	36	41.5	18.5	2.9	With Floating
QFP11T120-P050-01A	120	0.5	16X16	17x17	18X18	40	45.5	18.5	2.9	With Floating
QFP11T128-P050-01A	128	0.5	14X20	15x21	16X22	46	43	18.5	2.9	
QFP11T144-P050-01A	144	0.5	20X20	21x21	22X22	43	47	18.5	2.9	
QFP11T160-P050-01A	160	0.5	24X24	25x25	26X26	46	50	18.5	2.9	
QFP11T176-P050-01A	176	0.5	24X24	25x25	26X26	46	50	18.5	2.9	
QFP11T208-P050-01A	208	0.5	28X28	29x29	30X30	52	58	18.5	2.9	
QFP11T064-P065-01A	64	0.65	12x12	13x13	14X14	20	42	16.5	2.8	
QFP11T032-P080-01A	32	0.8	7x7	8x8	9X9	29	30	16.5	4	With Floating
QFP11T044-P080-01A	44	0.8	10x10	11x11	12X12	36	40	18.5	4.6	
QFP11T080-P080-01A	80	0.8	14x20	15x21	16X22	34	42.5	17	2.9	
QFP11T052-P100-01A	52	1.0	14X14	15x15	16X16	34.8	43	17	2.9	

### Open Top Type

Socket NO.	Pin Count	Pitch	Applicable Ic Dimensions(ref.)			Socket Outside Dimensions(ref.)				Remarks
			A	B	C	E	F	G	H	
OTQ11T064-P040-01A	64	0.4	7x7	8x8	9x9	24	24	19	3	
OTQ11T080-P040-01A	80	0.4	10x10	10.8x10.8	12x12	22	22	17.1	2.2	
OTQ11T100-P040-01A	100	0.4	12X12	13X13	14X14	24	24	17.1	2.2	
OTQ11T128-P040-01A	128	0.4	14x14	15x15	16x16	34	34	19	3	
OTQ11T144-P040-01A	144	0.4	16X16	17X17	18X18	28	28	17.1	2.2	
OTQ11T032-P050-01A	32	0.5	5X5	6x6	7X7	22	22	17	2.6	
OTQ11T048-P050-01A	48	0.5	7x7	8x8	9X9	24	24	16.5	2.6	
OTQ11T064-P050-01A	64	0.5	10x10	11X11	12X12	26.2	26.2	16.5	3	
OTQ11T064-P050-02A	64	0.5	10x10	11X11	12X12	26.2	26.2	16.5	3	
OTQ11T080-P050-01A	80	0.5	12x12	13x13	14X14	29	29	16.5	2.6	
OTQ11T100-P050-01A	100	0.5	14X14	15x15	16X16	32.2	32.2	16.5	2.6	
OTQ11T128-P050-01A	128	0.5	14X20	15x21	16X22	37	31	16.5	3	
OTQ11T144-P050-01A	144	0.5	20X20	21x21	22X22	37	37	16.5	2.6	
OTQ11T160-P050-01A	160	0.5	24X24	25x25	26X26	46.2	46.2	16.5	3	
OTQ11T208-P050-01A	208	0.5	28X28	29x29	30X30	45.6	45.6	16.5	3	
OTQ11T064-P065-01A	64	0.65	12x12	13x13	14X14	29	29	16.5	2.6	
OTQ11T032-P080-01A	32	0.8	7x7	8x8	9X9	25.5	25.5	17.5	2.6	
OTQ11T044-P080-01A	44	0.8	10x10	11x11	12X12	28.4	28.4	17.5	3	
OTQ11T080-P080-01A	80	0.8	14x20	15x21	16X22	42	36	17.5	2.6	

\*If you need further details or have any questions regarding other models ,please contact our local representative.





### ORDERING PROCEDURE

**SOP11T** □□□ - P□□□ - □□□ - □

**SOP21T** □□□ - P□□□ - □□□ - □ (Kelvin Type)

Pin Count      Pitch      Serial No.

Specification	
Contact resistance (Initial)	400mΩ or less (At 10 mA)
Maximum voltage	AC700V RMS (for 1 minute) Below 0.5mm pitch AC500V RMS (for 1 minute)
Rated current	1A
Insulation resistance	1,000MΩ or higher (At DC 500V)
Operating temperature range	- 65°C ~ +150°C
Insertion	Min. 5,000 times

Material	
Body	PPS,PES
Contact	BeCu, Au plating(Ni-base)

\*Rohs compliant

## APPLICABLE IC DIMENSIONS & SOCKET DIMENSIONS

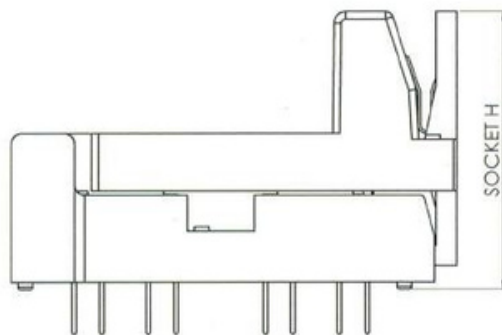
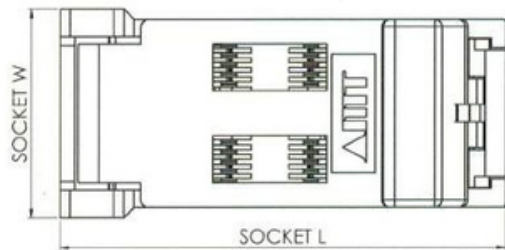
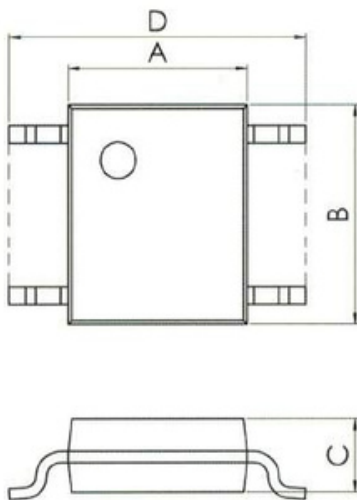



## SOP/SOT Socket Line Up (Pitch0.40-1.27mm)

Socket NO.	Pkg Name	Pkg Type	Pin Count	Pitch	Gnd	Applicable ic dimensions(REF.)				Socket outside dimensions(REF.)			Kelvin	Style	Remarks
						A	B	C	D	Socket W	Socket L	Socket H			
SOP11T008-P065-A1A-M	MSOP-8L	MSOP	8	0.65	No	3.00	3	0.85	4.9	12.70	28.9	18.40	No	ClamShell	Dual site
SOP21T008-P065-A2A-M	MSOP-8L	MSOP	8	0.65	No	3.00	3	0.85	4.9	12.70	28.9	18.40	Yes	ClamShell	Dual site
SOP21T008-P065-03A-M	HMSOP-8L	MSOP	8	0.65	Yes	3.00	3	0.85	4.9	12.70	28.9	18.40	Yes	ClamShell	
SOP21T004-P130-A1A-M	SMD-4L	SMD	4	1.3	No	1.25	2	0.85	2.2	12.6	25.4	17.85	Yes	ClamShell	
SOP11T008-P127-A1A-M	SOIC-8L	SOP	8	1.27	No	3.9	4.9	1.45	6	15.3	29.5	17.8	No	ClamShell	Dual site
SOP11T014-P127-A1A-M	SOP-14L	SOP	14	1.27	No	3.9	8.65	1.45	6	15.3	29.5	17.85	No	ClamShell	
SOP11T016-P127-A1A-M	SOP-16L	SOP	16	1.27	No	3.9	9.9	1.45	6	15.3	29.5	17.85	No	ClamShell	
SOP11T020-P127-A1A-M	SOP-20L	SOP	20	1.27	No	7.50	12.8	2.30	10.3	16.76	37.46	18.79	No	ClamShell	
SOP11T024-P127-A1A-M	SOP-24L	SOP	24	1.27	No	7.50	15.4	2.30	10.3	16.76	37.46	18.79	No	ClamShell	
SOP11T028-P127-A1A-M	SOP-28L	SOP	28	1.27	No	7.50	18	2.30	10.3	21.80	35.05	18.80	No	ClamShell	
SOP11T032-P127-A1A-M	SOP-32L	SOP	32	1.27	No	7.50	20.98	2.30	10.3	26.70	42	19.05	No	ClamShell	
SOP21T008-P127-A1A-M	SOIC-8L	SOP	8	1.27	No	3.9	4.9	1.45	6	15.3	29.5	17.8	Yes	ClamShell	Dual site
SOP21T008-P127-01A-M	ESOP-8L	SOP	8	1.27	Yes	3.9	4.9	1.45	6	15.3	29.5	17.8	Yes	ClamShell	
SOP21T014-P127-A1A-M	SOP-14L	SOP	14	1.27	No	3.9	8.65	1.45	6	15.3	29.5	17.85	Yes	ClamShell	
SOP21T016-P127-03A-M	ESOP-16L	SOP	16	1.27	Yes	3.9	9.9	1.45	6	15.3	29.5	17.85	Yes	ClamShell	
SOP21T016-P127-04A-M	HSOP-16L	SOP	16	1.27	No	3.9	9.9	1.45	6	15.3	29.5	17.85	Yes	ClamShell	
SOP21T016-P127-09A-M	SOP-16L	SOP	16	1.27	No	3.9	9.9	1.45	6	15.3	29.5	17.85	Yes	ClamShell	
SOP21T020-P127-A1A-M	SOP-20L	SOP	20	1.27	No	7.50	12.8	2.30	10.3	16.76	37.46	18.79	Yes	ClamShell	
SOP21T024-P127-A1A-M	SOP-24L	SOP	24	1.27	No	7.50	15.4	2.30	10.3	16.76	37.46	18.79	Yes	ClamShell	
SOP21T028-P127-A1A-M	SOP-28L	SOP	28	1.27	No	7.50	18	2.30	10.3	21.80	35.05	18.80	Yes	ClamShell	
SOP21T032-P127-A1A-M	SOP-32L	SOP	32	1.27	No	7.50	20.98	2.30	10.3	26.70	42	19.05	Yes	ClamShell	
SOP11T006-P065-A1A-M	SC-70	SOT	6	0.65	No	1.25	2	0.9	2.1	12.95	27.94	18.79	No	ClamShell	Dual site
SOP11T008-P065-01A-M	TSOT23-8L	SOT	8	0.65	No	1.6	2.9	1	2.8	14	26.9	18.1	No	ClamShell	Dual site
SOP21T006-P065-A1A-M	SC-70	SOT	6	0.65	No	1.25	2	0.9	2.1	12.95	27.94	18.79	Yes	ClamShell	Dual site
SOP21T006-P065-A2A-M	SOD323	SOT	6	0.65	No	1.25	2.1	0.95	2.3	12.6	25.4	17.85	Yes	ClamShell	Dual site
SOP21T006-P095-A1A-M	TSOT23	SOT	6	0.95	No	1.6	2.92	0.95	2.8	14	18.4	18.15	Yes	ClamShell	Dual site
SOP21T006-P150-01A-M	SOT89-5L	SOT	5	1.50	No	2.5	4.5	1.5	4.1	13	26.8	17.75	Yes	ClamShell	
SOP21T008-P065-01A-M	TSOT23-8L	SOT	8	0.65	No	1.6	2.9	1	2.8	14	26.9	18.1	Yes	ClamShell	Dual site
SOT11T006-P095-A1A-M	SOT23-6L	SOT	6	0.95	No	1.6	2.92	1.1	2.8	14	18.4	18.15	No	ClamShell	Dual site
SOT21T003-P230-01A-M	SOT223	SOT	3	2.30	No	3.5	6.5	1.6	7	12.6	25.5	17.85	Yes	ClamShell	
SOT21T004-P130-01A-M	SOT343	SOT	4	1.30	No	1.25	2	0.85	2.2	12.95	25.4	?	Yes	ClamShell	Dual site
SOT21T005-P095-A1A-M	SOT-523	SOT	5	0.95	No	1.6	2.92	1.1	2.8	14	18.4	18.15	Yes	ClamShell	Dual site
SOT21T006-P065-01A-M	SOT363	SOT	6	0.65	No	1.25	2	0.95	2.2	14	26.8	17.8	Yes	ClamShell	Dual site
SOT21T006-P095-01A-M	SOT23-6L	SOT	6	0.95	No	1.6	2.92	0.97	2.74	14	27	18	Yes	ClamShell	Dual site
SOT21T006-P095-02A-M	SOT23-6L	SOT	6	0.95	No	1.6	2.92	1.1	2.8	14	18.4	18.15	Yes	ClamShell	Dual site
SOP11T020-P065-A1A-M	SSOP-20L	SSOP	20	0.65	No	3.9	8.65	1.4	6	15.75	34.04	19.05	No	ClamShell	
SOP11T024-P065-A1A-M	SSOP-24L	SSOP	24	0.65	No	3.9	8.65	1.4	6	15.75	34.04	19.05	No	ClamShell	
SOP11T028-P0635-A1A-M	SSOP-28L	SSOP	28	0.64	No	3.9	9.9	1.4	6	15.75	34.04	19.05	No	ClamShell	
SOP11T028-P065-A1A-M	SSOP-28L	SSOP	28	0.65	No	5.3	10.2	1.75	7.8	15.75	34.04	19.05	No	ClamShell	
SOP21T020-P065-A1A-M	SSOP-20L	SSOP	20	0.65	No	3.9	8.65	1.4	6	15.75	34.04	19.05	Yes	ClamShell	
SOP21T024-P065-A1A-M	SSOP-24L	SSOP	24	0.65	No	3.9	8.65	1.4	6	15.75	34.04	19.05	Yes	ClamShell	
SOP21T028-P0635-A1A-M	SSOP-28L	SSOP	28	0.64	No	3.9	9.9	1.4	6	15.75	34.04	19.05	Yes	ClamShell	
SOP21T028-P065-A1A-M	SSOP-28L	SSOP	28	0.65	No	5.3	10.2	1.75	7.8	15.75	34.04	19.05	Yes	ClamShell	
SOP11T008-P065-A2A-M	TSSOP-8L	TSOP	8	0.65	No	3	4.4	1	6.4	12.95	31.75	18.79	No	ClamShell	
SOP11T010-P065-A1A-M	TSSOP-10L	TSOP	10	0.5	No	3	3	1	5	12.95	30.48	18.79	No	ClamShell	
SOP11T016-P065-A1A-M	TSSOP-16L	TSOP	16	0.65	No	4.4	5	1	6.4	12.95	31.75	18.79	No	ClamShell	
SOP11T020-P065-A2A-M	TSSOP-20L	TSOP	20	0.65	No	4.4	5	1	6.4	12.95	31.75	18.79	No	ClamShell	
SOP11T024-P065-A2A-M	TSSOP-24L	TSOP	24	0.65	No	4.4	7.8	1	6.4	12.95	31.75	18.79	No	ClamShell	
SOP11T028-P065-A2A-M	TSSOP-28L	TSOP	28	0.65	No	4.4	9.7	1	6.4	12.95	31.75	18.79	No	ClamShell	
SOP21T008-P065-A1A-M	TSSOP-8L	TSOP	8	0.65	No	3	4.4	1	6.4	12.95	31.75	18.79	Yes	ClamShell	
SOP21T010-P065-A1A-M	TSSOP-10L	TSOP	10	0.5	No	3	3	1	5	12.95	30.48	18.79	Yes	ClamShell	
SOP21T016-P065-A1A-M	TSSOP-16L	TSOP	16	0.65	No	4.4	5	1	6.4	12.95	31.75	18.79	Yes	ClamShell	
SOP21T020-P065-A2A-M	TSSOP-20L	TSOP	20	0.65	No	4.4	5	1	6.4	12.95	31.75	18.79	Yes	ClamShell	
SOP21T024-P065-A2A-M	TSSOP-24L	TSOP	24	0.65	No	4.4	7.8	1	6.4	12.95	31.75	18.79	Yes	ClamShell	
SOP21T028-P065-A2A-M	TSSOP-28L	TSOP	28	0.65	No	4.4	9.7	1	6.4	12.95	31.75	18.79	Yes	ClamShell	

\*If you need further details or have any questions regarding other models ,please contact our local representative.





# TEST SOCKET

(Applicable IC/TSOP&QFP)

# MEMORY TEST SOCKETS

## ORDERING PROCEDURE

T- □□□ - □.□□ - □□□  
 TSSOP11Y □□□ - □.□□ - □□□  
 QFP11Y □□□ - □.□□ - □□□

Pin Count      Pitch      Serial No.



Specification	
Contact resistance (Initial)	30mΩ or less (At 10 mA)
Maximum voltage	AC700V RMS (for 1 minute) Below 0.5mm pitch AC500V RMS (for 1 minute)
Insulation resistance	1,000MΩ or higher (At DC 500V)
Operating temperature range	- 65°C ~ +150°C
Insertion	Min. 10,000 times

Material	
Body	PPS,PES
Contact	BeCu, Au plating(Ni-base)

\*Rohs compliant

## APPLICABLE IC DIMENSIONS

TSOP  
QFP

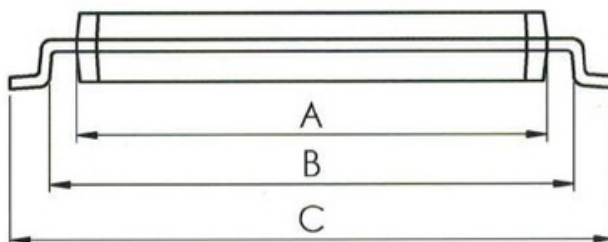



# TEST SOCKET

(Applicable IC/TSOP&QFP)

MEMORY TEST SOCKETS

## TSOP/QFP Socket Line up

Socket NO.	Pkg Type	Pin Count	Pitch	Applicable ic dimensions(REF.)			Remarks
				A	B	C	
T-28-055P-A01-0	TSSOP	28	0.55	11.8	12.2	13.4	
T-32-050P-A01-0	TSSOP	32	0.5	11.8	12.2	13.4	
T-40-050P-B01-0	TSSOP	40	0.5	12.4	12.8	14	
T-44-080P-B01-0	TSSOP	44	0.8	10.06	10.76	11.76	
T-48-050P-A01-0	TSSOP	48	0.5	18.4	19	20	
T-48-050P-A02-0	TSSOP	48	0.5	18.4	19	20	
T-48-050P-B01-0	TSSOP	48	0.5	18.4	19	20	
T-56-050P-A01-0	TSSOP	56	0.5	18.4	19	20	
T-86-050P-B01-0	TSSOP	86	0.5	10.2	10.76	11.76	
TSSOP11Y032-P127-01A	TSSOP	32	1.27	10.16	10.76	11.76	
TSSOP11Y044-P080-01A	TSSOP	44	0.8	10.16	10.76	11.76	
TSSOP11Y054-P080-01A	TSSOP	54	0.8	10.16	10.76	11.76	
TSSOP11Y066-P065-01A	TSSOP	66	0.65	10.16	11.03	11.76	
TSSOP11Y086-P050-01A	TSSOP	86	0.5	10.16	11.03	11.76	
QFP11Y100-P065-01A	QFP	100	0.5	14	14.9	16	

\*If you need further details or have any questions regarding other models, please contact our local representative.





### To3 Power In-line Socket

- Accepts a wide variety of in-line devices up to 3 leads including TO-3 and TO-66
- Kelvin contacts
- Repairable – body and contacts replaceable
- Slotted out 2 entry ports accept devices with 1.90 mm to 5.1 mm between leads
- Must be mounted to board with screws

Specification	
Contact resistance (Initial)	30mΩ max
Maximum voltage	AC1000V RMS (for 1 minute)
Rated current	1A
Insulation resistance	>1x10 <sup>12</sup> (At DC 500V)
Operating temperature range	- 65°C ~ +150°C
Insertion	10,000 cycles

Material	
Body	PPS,PES
Contact	Beryllium Copper, Au plating( Ni-base)

\*Rohs compliant

## APPLICABLE IC DIMENSIONS

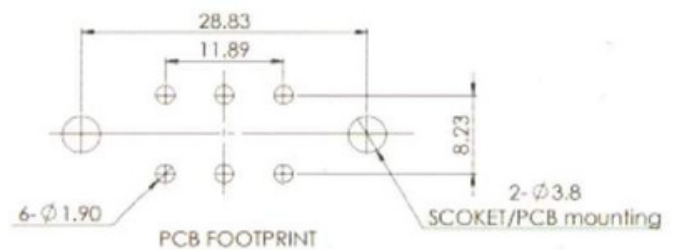
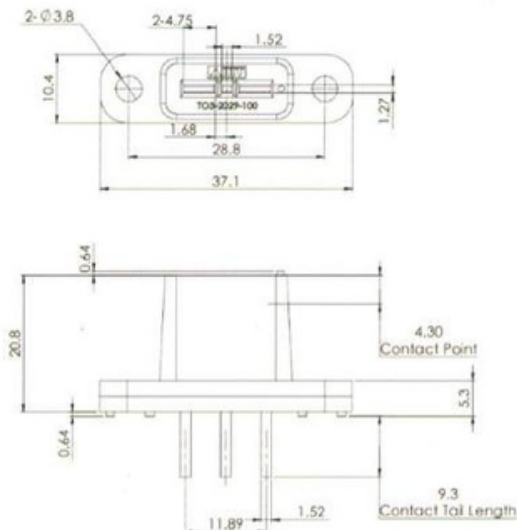



# Cables&High-Speed Interconnect

Advance Microelectronic Technology Co., Limited provides custom cable assemblies to OEMs in a variety of markets in the electronics industry. we serve worldwide markets with cost-effective solutions specializing in Medical, Automatic Test Equipment (ATE), Computer and Power Connector Products.

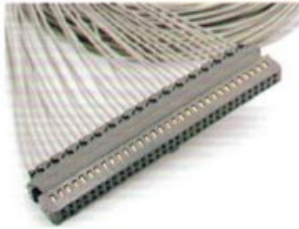

64-pin Header Connector/Cable Assembly for Automatic Test Equipment (ATE) applications

- 32 coax signals or up to 64 utility pins
- 3 GHz bandwidth
- 10,000 insertion cycles



2.54Pitch-2 Position/Single signal connector & Carrier Systems

- Impedance control and meet the requirements of high speed and low crosstalk cables are designed for single or differential mode transmission lines and are available with impedance from 50 to 100 ohms.
- Square socket terminations may be housed individually or consolidated into multi-position carrier systems for grouped interfacing with single, dual or triple row headers.
- Variety of connectors such as BNC, SMA, SMB, or SMC may be used on opposite ends to meet specific application requirements.
- 100% electrically tested.

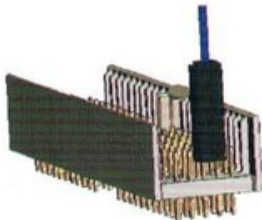

2mm- 2 Position connector

- 2mm-2Position square Terminations
- 3 GHz Bandwidth when using coax
- Use with Coax or Hook Up wire for signals or power delivery
- 100% electrically tested



RF Coaxial cable & Connectors

Rugged solutions for reliable RF connectivity that is engineered to work at radio frequencies ranging from a few MHz to over 100 GHz. RF connectors maintaining low insertion losses, superb voltage standing wave ratio, and other mechanical and electrical functi.



PCB Terminations

- Solderable terminations for miniature coax, 3 GHz Bandwidth when using coax.
- Square socket terminations offer, 2.54mm pitch centerline, high-performance, cost-effective terminations.
- Axial or right angle cable exits.
- 100% electrically tested.



# ELECTRONIC CONNECTORS

---

## Custom Pogo Pin Blocks

Our pogo pin blocks and interfaces are designed for a variety of situations in almost any configuration. Pin blocks are available for board-to-board, board-to-DUT, and fixture-to-board connection systems. Coaxial pins within the pogo pin block provide shielded interconnection to ensure the integrity of the transmitted signal.

Our pin blocks and interfaces accommodate a range of physical and electrical test requirements to meet your applications. If you have specific performance requirements, contact us and we can provide electrical data on our pogo pins block.

### Features:

- Robust electrical and physical design for reliable operation.
- Flexible customized design to meet customizer Needs.
- Comprehensive electrical simulation design technology.
- Combined with high quality coaxial cable.

